

PLAN OF SUBDIVISION

EDITION 1

PS 829824 E

LOCATION OF LAND

PARISH: Drouin West

TOWNSHIP:

SECTION:

CROWN ALLOTMENT: 53 (PT)

CROWN PORTION:

TITLE REFERENCE: Vol. Fol.

LAST PLAN REFERENCE: Lot B PS 842192R

POSTAL ADDRESS: 175 McGlone Road, Drouin 3818
(at time of subdivision)

MGA CO-ORDINATES: E: 397 000 ZONE: 55
(of approx centre of land in plan) N: 5 782 500 GDA 2020

Council Name: Baw Baw Shire Council

SPEAR Reference Number: S150466J

VESTING OF ROADS AND/OR RESERVES

NOTATIONS

IDENTIFIER	COUNCIL/BODY/PERSON
Road R-1	Baw Baw Shire Council
Road R-2	Baw Baw Shire Council
Reserve No.1	Baw Baw Shire Council

Area of land in plan: 12.25ha
Comprising of - 27 Lots: 1.563ha
2 Balance Lots: 8.546ha
2 Road Reserves: 3600m²
1 Council Reserve: 1.776ha

NOTATIONS

DEPTH LIMITATION: DOES NOT APPLY

SURVEY:
This plan is based on survey.

STAGING:
This is not a staged subdivision.
Planning Permit No.

This survey has been connected to permanent marks No(s). 55, 160, 187, 188, 236,
237, 295 & 296
In Proclaimed Survey Area No. --

Other Purpose of Plan

1. Removal of part of the Easement shown as E-3 on PS 842192R, being a Pipeline or Ancillary Purposes Easement in favour of Central Gippsland Region Water Corporation created in PS 842192R.
2. Removal of part of the Easement shown as E-3 on PS 842192R, being a Drainage Easement in favour of Baw Baw Shire Council created in PS 842192R.

Grounds for Removal

Schedule 5 Clause 14 of the Road Management Act 2004.

EASEMENT INFORMATION

LEGEND: A - Appurtenant Easement E - Encumbering Easement R - Encumbering Easement (Road)

Easement Reference	Purpose	Width (Metres)	Origin	Land Benefited/In Favour Of
E-1, E-3 & E-5	Pipeline or Ancillary Purposes	See Plan	PS 842192R	Central Gippsland Region Water Corporation
E-2 & E-3	Drainage	See Plan	PS 842192R	Baw Baw Shire Council
E-4 & E-5	Creation and maintenance of wetlands, floodway and drainage as specified and set-out in Memorandum of Common Provisions no. AA2741	See Plan	This Plan	Melbourne Water Corporation

NOBELIUS LAND SURVEYORS



P.O. BOX 461
PAKENHAM 3810
Ph 03 5941 4112
mail@nobelius.com.au

SURVEYORS FILE REF: 17601-S1

Digitally signed by: Benjamin Stephen Nobelius, Licensed Surveyor,
Surveyor's Plan Version (F),
17/06/2020, SPEAR Ref: S150466J

ORIGINAL SHEET
SIZE: A3

SHEET 1 OF 5

PS 829824 E

Reserve No.1



McGLONE ROAD

7°15'50" 310.68

221.68

7°15'50"

E-1

6

SEE SHEET 2

E-4

E-4

6
E-5

E-1

SEE SHEET 4

(50.38)
E-5 2.5
(51.64)
183°42'50"

97°52'20"
35.07

E-4

E-5 2.5

32.50

2.5

E-1

2.5

E-1

7°15'50"
(45.37)

E-1

2.5

26.24

97°15'50"
22.46

E-3

116.50

E-3

7°15'50"

70.60

5

16°35' C/L165
A/L2.39 R/65

39.67
1°30'
39.33

3

91°30'
6
E-3
35
35.61
1°30'
6

SEE SHEET 5

E-4

NOBELIUS LAND SURVEYORS

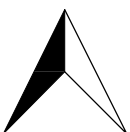

P.O. BOX 461
PAKENHAM 3810
Ph 03 5941 4112
mail@nobelius.com.au

SCALE
1:500

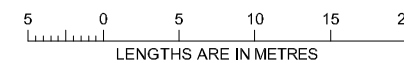

ORIGINAL SHEET
SIZE: A3

SHEET 3

Digitally signed by: Benjamin Stephen Nobelius, Licensed Surveyor,
Surveyor's Plan Version (F),
17/06/2020, SPEAR Ref: S150466J

WARNING - This document is a working document in the SPEAR approval process. It is subject to revision and change and therefore should not be relied on. If you have any questions about this document please contact the person from Nobelius Land Surveyors Pty Ltd who gave you access to SPEAR / this document. SPEAR Ref: S150466J 22/06/2020 10:20 am

SEE SHEET 3

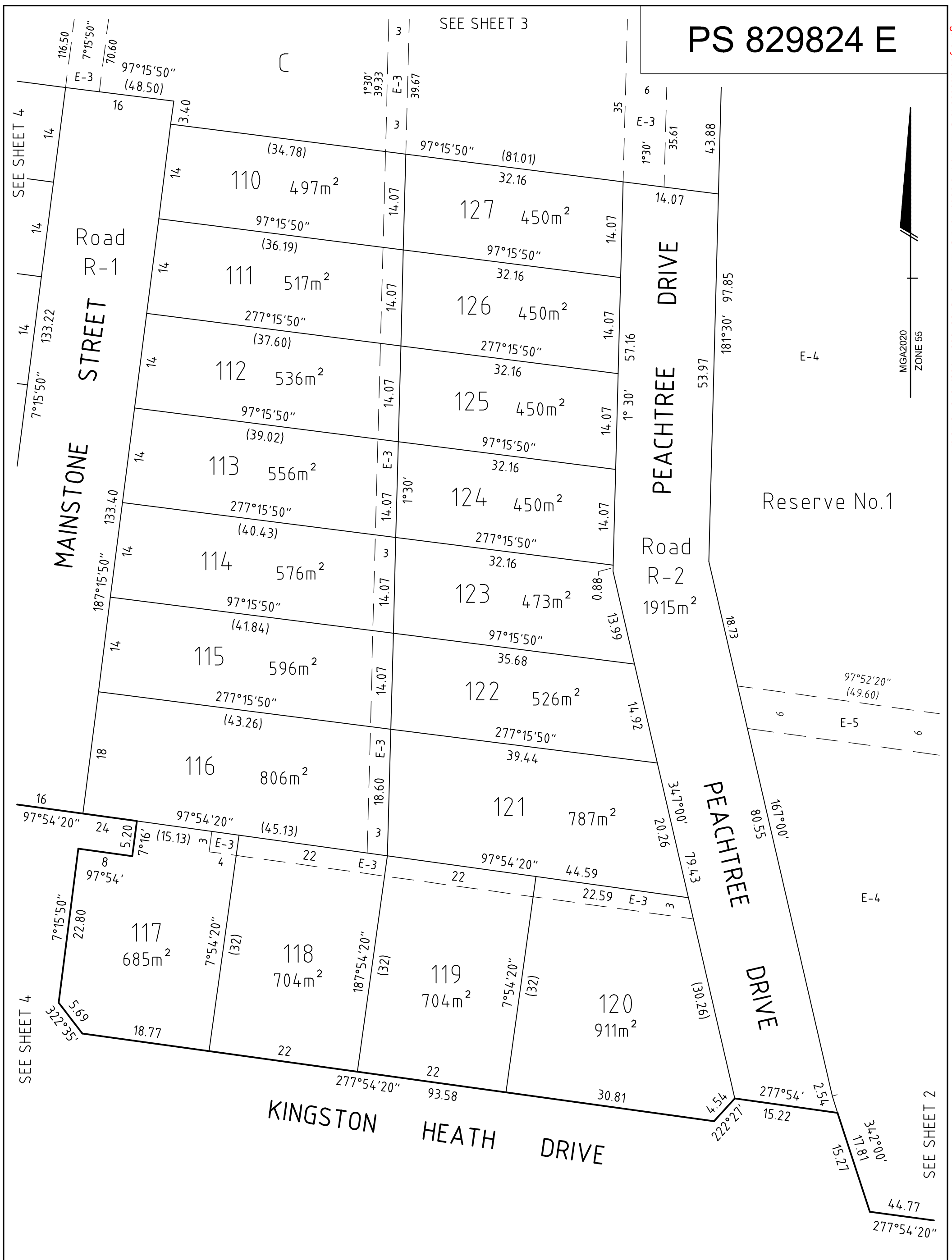

NOBELIUS LAND SURVEYORS

P.O BOX 461
 PAKENHAM 3810
 Ph 03 5941 4112
 mail@nobelius.com.au

SCALE
 1:500

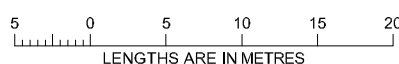

Digitally signed by: Benjamin Stephen Nobelius, Licensed Surveyor,
 Surveyor's Plan Version (F),
 17/06/2020, SPEAR Ref: S150466J

ORIGINAL SHEET
 SIZE: A3

SHEET 5

WARNING - This document is a working document in the SPEAR approval process. It is subject to revision and change and therefore should not be relied on. If you have any questions about this document please contact the person from Nobelius Land Surveyors Pty Ltd who gave you access to SPEAR / this document. SPEAR Ref: S150466J 22/06/2020 10:20 am